



LEGEND:

-  ACQUISITION
-  TEMPORARY CONSTRUCTION EASEMENT
-  ROW ACQUIRED IN INTERIM

PROPOSED PROJECT ACQUISITION								
Number	PARCEL NUMBER	OWNER	TOTAL PARCEL SIZE (ACRES)	ACQUISITION IN INTERIM (ACRES)	ACQUISITION IN ULTIMATE (ACRES)	TOTAL ACQUISITION (ACRES)	TEMPORARY EASEMENT (ACRES)	REMNANTS (ACRES)
1	058-0280-007	Conrad	0.911	0.177		0.177		
2	058-0280-003	River Road Partners	3.530	1.005	0.056	1.061	0.012	
3	058-0280-006	Roberts	0.473	0.056		0.056		
4	058-0280-005	Equilon Enterprise	6.010	2.920	0.200	3.120	0.065	
5	058-0270-014	Ramos	7.568	0.120		0.120		
6	009-0020-001	Phillips 66 Company	1.525	0.605		0.605		
7	009-0012-064	Phillips 66 Company	2.673	2.673		2.673		
8	009-0012-065	Chevron USA Inc.	0.793	0.793		0.793		
9	009-0012-038	PG & E	0.033	0.033		0.033		
10	009-0012-008	Chevron USA Inc.	1.598	0.220		0.220		
11	009-0030-054	Phillips 66 Company	5.616	0.657		0.657		
12	009-0012-071	Chevron USA Inc.	2.494	0.378		0.378		
13	009-0012-072	Chevron USA Inc.	6.903	0.049		0.049		
14	843-57-5-7	UPRR	6.477	0.064		0.064		
15	058-0270-006	Ramos	2.579		0.023	0.023	0.013	
TOTAL			49.185	9.751	0.279	10.030	0.091	0.000

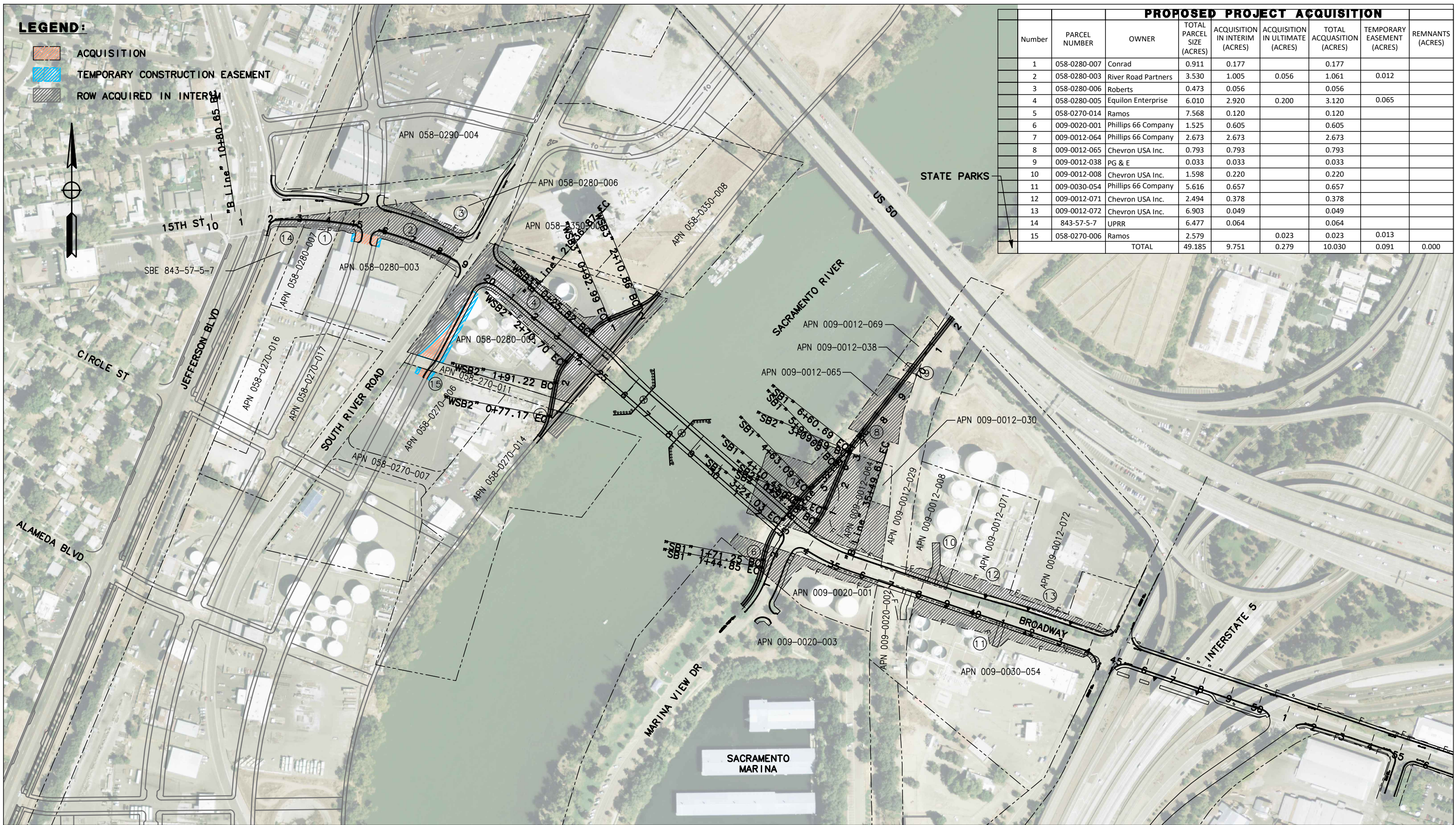

ALTERNATIVE B-ULTIMATE

**BROADWAY BRIDGE
RIGHT OF WAY ACQUISITION**

SCALE: 1"=150'
SEPTEMBER 2019

 **MARK
THOMAS**